

PUNZÓN CABEZA CILÍNDRICA MECHADOS CON EXPULSOR 833E

SHOULDER PUNCH EJECTOR

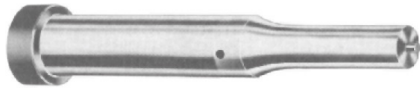

Ref. 833E

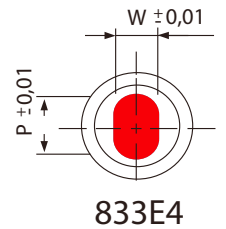
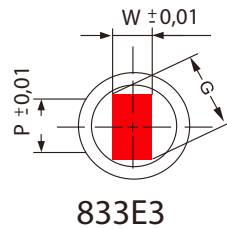
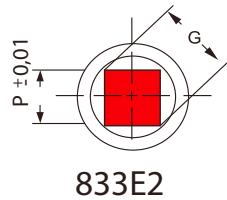
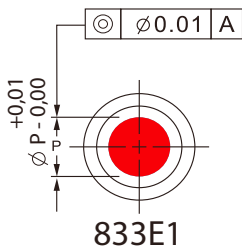
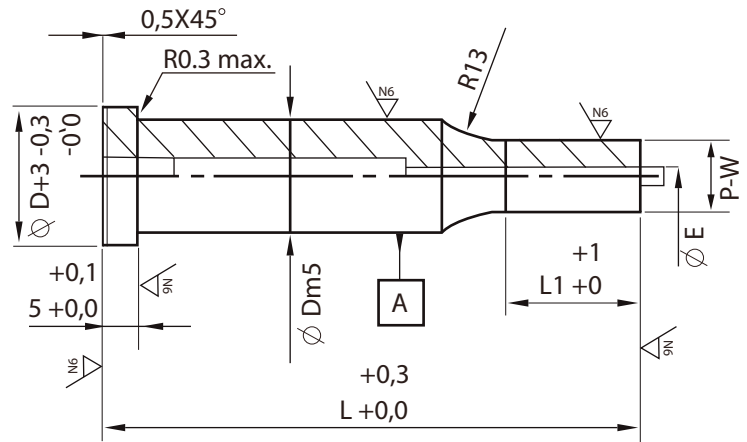

D	L1		P Range	W Min.	P-G Max.	L				
	Standard	Alternatives				71	80	90	100	125
5	13	19 / 25	1.60 - 4.95	1.60	4.95	●	●	●	●	●
6	13	19 / 25	1.60 - 5.95	1.60	5.95	●	●	●	●	●
8	19	13 / 25	2.50 - 7.95	2.50	7.95	●	●	●	●	●
10	19	13 / 25	3.20 - 9.95	3.20	9.95	●	●	●	●	●
13	19	13 / 25	5.00 - 12.95	4.50	12.95	●	●	●	●	●
16	19	13 / 25	8.00 - 15.95	6.00	15.95	●	●	●	●	●
20	19	13 / 25	10.00 - 19.95	8.00	19.95	●	●	●	●	●
25	19	13 / 25	12.00 - 24.95	9.00	24.95	●	●	●	●	●
32	25	13 / 19	16.00 - 31.95	10.00	31.95	●	●	●	●	●

MATERIAL / MATERIAL:

HSS M2 1.3343 HRc 60 - 63
 HWS A2 1.2379 HRc 58 - 62
 ASP23 HRc 63 - 66

Fabricación en HSS salvo indicaciones.
Standard manufacture in HSS.

EJEMPLO DE PEDIDO / ORDER EXAMPLE:

833E4 D-13 P-8 W-5 L-80-0°

*Fabricamos bajo plano cualquier medida

***We are manufacture special dimensions according dwg**